

The Folding Sliding Door Company

Door Option Calculator & Order Form

Door Measurements

Page 1 of 4

Frame Height

Measured from the underside of the top support to the underside of the bottom track minus tolerance

 mm

Frame Width

Measurement from wall to wall of the opening minus tolerance

 mm

Square Metres

Area of the door
The door weight is
Approx. 30kgs per m²

 m²

We recommend that you allow between 10mm and 20mm of tolerance between the opening structure and the door frame to allow easy installation

Amount of height tolerance allowed

 mm

Amount of width tolerance allowed

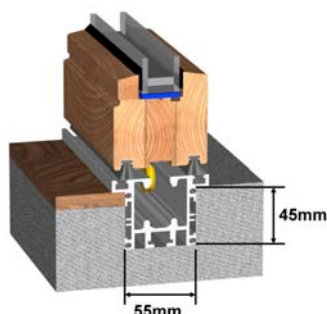
 mm

Always include the bottom track in your measuring and remember to allow for your floor finishes, tiles, carpet, etc...

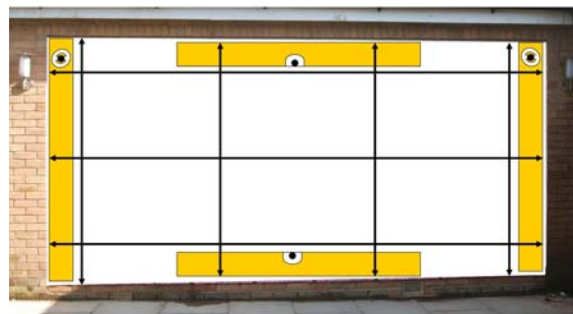

When measuring it is advisable to use a spirit level to indicate the correct size of door you require.
Note: Always use the smallest measurement.

Material Required

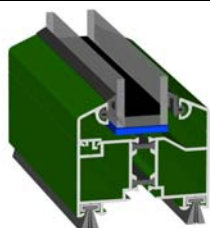

70mm Thermally Efficient Aluminium

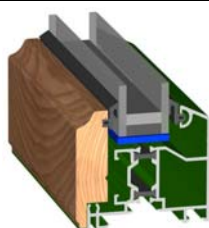

70mm Thermally Efficient Aluminium with Timber



45mm Thermally Efficient Aluminium

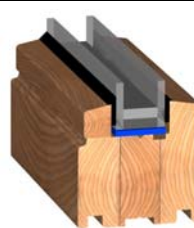

Laminated Thermally Efficient Oak

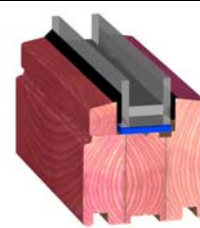

Laminated Thermally Efficient Meranti

Select the required material by marking an X in the box

☐
☐
☐
☐
☐

Opening Configurations

Note: All folding sliding doors are viewed from the inside only.

How many door panels would you like to fold to the:

LEFT

RIGHT

Which side of the opening would you like the door panels to stack when they are open?

INSIDE

☐

OUTSIDE

☐

Place an X in the appropriate box

Trickle Vents

Trickle vents are fitted to the top track and allow air flow. They are required by most building controllers. You should allow 1 trickle vent per centred metre of door width.
E.g. a 3000mm wide door would require 2 trickle vents.

Number of trickle vents required

Name

Postal Code

Date

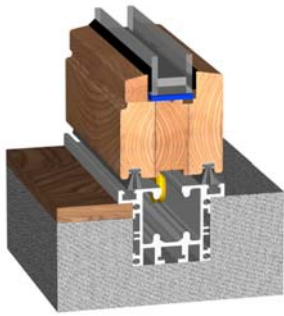

Standard Flush Track

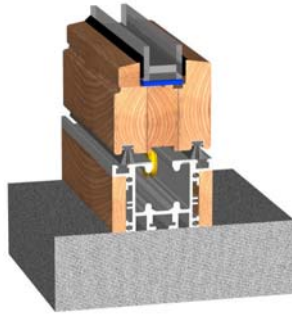
☐

Raised Track

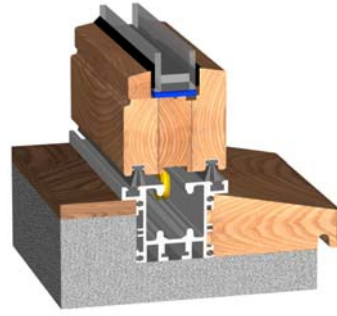
☐

Flush Track with Sill

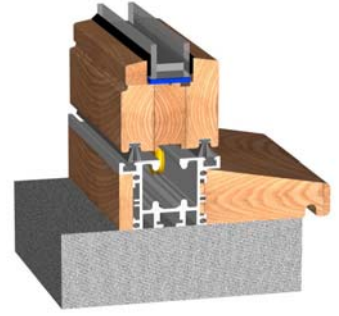
☐

Raised Track with Sill

☐

Select the required bottom track detail by marking an X in the box.

Note: The timber images are for illustration purposes only. The same details are used for aluminium with an aluminium sill and track cover. The flush track is supplied as standard with no extra cost.

Bottom Track Rebate

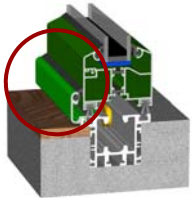

Powder coated bottom rebate

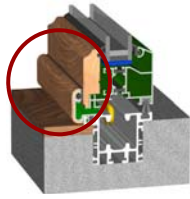
☐

Wood veneered Bottom rebate

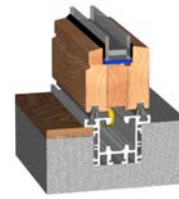
☐

No bottom Rebate required

☐

80mm Mullions

Mullions are horizontal glazing bars that match the profile of the door. It divides the glass into two separate units, a unit at the top and a unit at the bottom of each door panel. The mullion is fitted to the panel at an indicated measurement - From the bottom of the panel to the centre of the mullion.

Mullions are required

☐

Centre height of the mullion

 mm

Colours, Coatings & Assembly

Whether you choose aluminium or timber we can coat your door in any RAL colour. A RAL colour chart is available from your local paint supplier. Our timber doors can also be supplied to you uncoated for DIY coating or in our standard range of factory sprayed finishes.

Standard Factory Sprayed Finishes



Pine

☐

Dark Teak

☐

New Oak

☐



Mature Oak

☐

Mahogany

☐

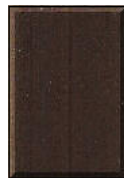

Rosewood

☐

Walnut

☐

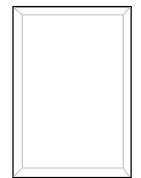
Ebony

☐

9016 White

☐

Aluminium, Timber RAL Coatings and Assembly

RAL Colour Number

9016 White

☐

Gloss, Matt, Satin

☐

Other

Assembly

☐

Factory Assembly includes the fitting of all hinges, gaskets, seals and locks. If it is not selected, the door will be supplied as a self assembly kit.

Gaskets & Seals

EPDM gaskets are used to seal the double glazed units into the panels and protect the door from water ingress. There are EPDM seals between each panel prevent water, wind and noise from entering the property.

The gaskets and seals are available in black, white and brown.

Black

☐

White

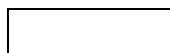
☐

Brown

☐

Hinges

The hinges are available in black, white and bronze

Black

☐

White

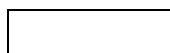
☐

Bronze

☐

Name

Postal Code

Date



Flat handles are required on each bi-fold to allow the panels to fold around the handle without obstructing the fold. All door systems are supplied with the correct amount of flat handles required inside. These handles are available in: Black, White, Gold and Chrome. You can also choose to purchase extra flat handles if you would like them on the outside of a bi-fold.

Required colour of flat handles	Black	White	Gold	Chrome	Number of extra flat handles
	<input type="checkbox"/>	<input type="checkbox"/>	<input type="checkbox"/>	<input type="checkbox"/>	<input type="text"/>

High Security Lever Handle



The high security lever handle enables the lock on the swing panel to be operated easily and provides protection from cylinder attack by a prospective intruder.

The handle completely covers the cylinder and permits the key to be inserted into the cylinder through a slot in a stainless steel spinning disc.

The lever handle can however prevent the panel from folding completely flat on the folding side of the door. To prevent this the lever handle can be exchanged for a flat handle attached to the high security back plate.

Chrome security handle	<input type="checkbox"/>	Flat handle attached	<input type="checkbox"/>
Gold security handle	<input type="checkbox"/>		



Cylinder Locks



Half Cylinder

Half cylinders can be used where two panels fold (A Bi-fold). A lock is placed at the point(s) indicated below to secure the bi-fold when closed. This can be key locked with a cylinder

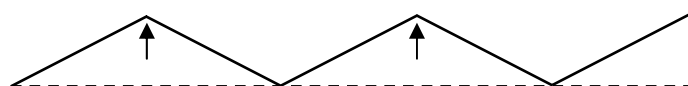

Number of half cylinders required



Full Cylinder

Full cylinders can be used where a single panel is used as a swing door. A lock is placed at the point indicated below to secure the swing panel when closed. This can be key locked with a cylinder.

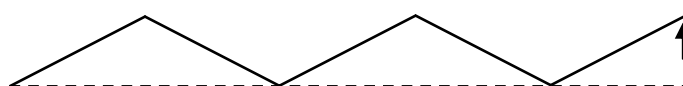

Number of full cylinders required

Keyed Alike Cylinders

In some cases, e.g. a 6 panel door set with 3 left and 3 right, you may require 2 half cylinders and 1 full cylinder, with 3 different keys. You can have 1 key that will operate all 3 cylinders at an extra charge per cylinder = Keyed Alike.

Number of keyed alike cylinders

Glass

We have several glass options for you to choose from. All of our glass units are double glazed with a Low-E (K) coating on the inside.

- (1) Standard glass is 4mm tempered glass outside, 16mm or 20mm cavity and 4mm tempered Low-E glass on the inside.
- (2) Security glass is 6.4mm laminated glass outside, 14mm or 18mm cavity and 4mm tempered Low-E glass on the inside.
- (3) Self cleaning double glazed units. (4) Anti-Sun Tinted double glazed units with Bronze/Grey/Green glass

Argon and Krypton gas filling for improved U-Values are also available

Standard double glazed units	Security double glazed units	Self cleaning double glazed units	Anti-sun double glazed units	Gas Filling
<input type="checkbox"/>	<input type="checkbox"/>	<input type="checkbox"/>	Bronze <input type="checkbox"/>	No gas <input type="checkbox"/>
			Grey <input type="checkbox"/>	Argon <input type="checkbox"/>
			Green <input type="checkbox"/>	Krypton <input type="checkbox"/>

Place X in the box of the glass or gas option that you require

Name	<input type="text"/>	Postal Code	<input type="text"/>	Date	<input type="text"/>
------	----------------------	-------------	----------------------	------	----------------------

Order Form

Your Details

Page 4 of 4

Name:	Site Contact:
Address:	Delivery Address:
Postal Code:	Postal Code:
Tel: Mob:	Email: Fax:

Timber Clad Required

Timber Clad for 70mm Aluminium with Timber System ONLY

Knotty Pine ☐ Douglas Fir ☐ European Oak ☐ Meranti ☐ Other

Trickle Vent Colour

Black ☐

White ☐

Brown ☐

Installation & Delivery

Installation

I would like my door(s) to be installed by FSDI.



I will be arranging my own installation.



Delivery

I would like my door(s) to be delivered.



I will be arranging collection from your factory.



Notes

All details set out on this order are correct and I now request that manufacture of this door set be carried out to its entirety. By placing an order with you I agree to all terms and conditions of sale.

Signed: _____ Print: _____ Date: _____

Folding Sliding Doors Limited

Registered in England and Wales at: FSD Works, Hopbine Avenue, West Bowling, Bradford, West Yorkshire. BD5 8ER.

Tel: 0845 644 6630 Fax: 0845 644 6631 Email: sales@foldingslidingdoors.com

Company registration number: 4267386 Vat registration number: 779829547